

DO NOT SCALE

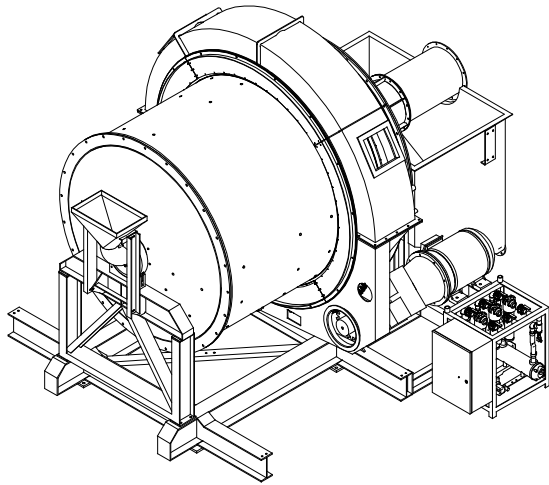

1:25

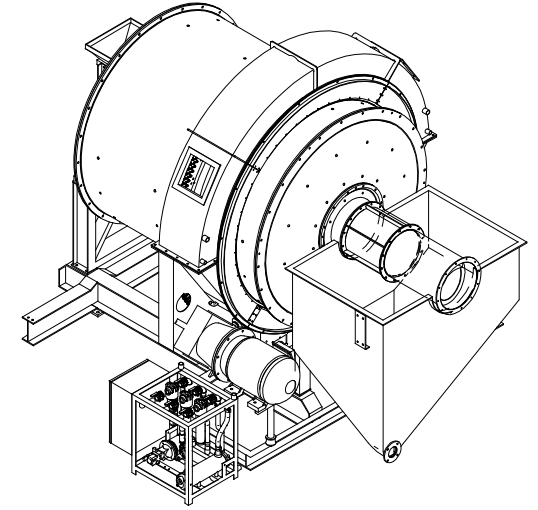
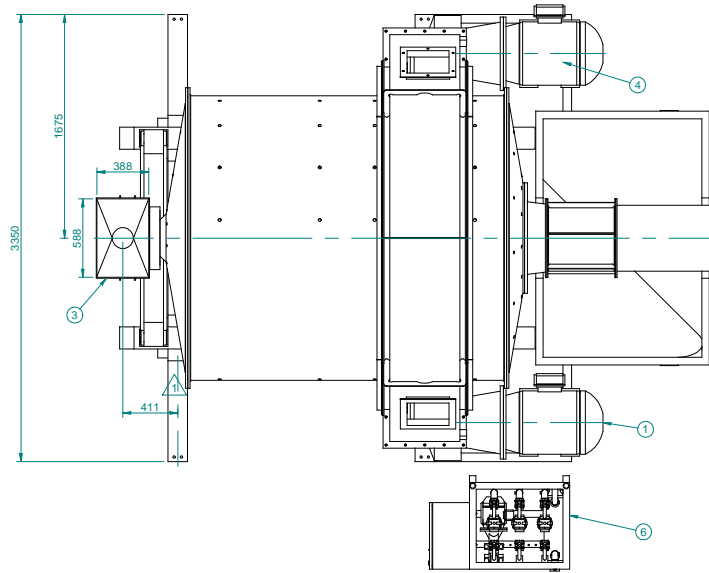

1:25

LOADS ON BEAM FEED END BEARING

DEAD LOAD : 7 KN
 ROTATING LOAD : 43 KN
 PROCESS LOAD : 57 KN

LOAD ON BEAM UNDER DRIVE BEARING

DEAD LOAD : 40 KN
 ROTATING LOAD : 125 KN
 PROCESS LOAD : 114 KN

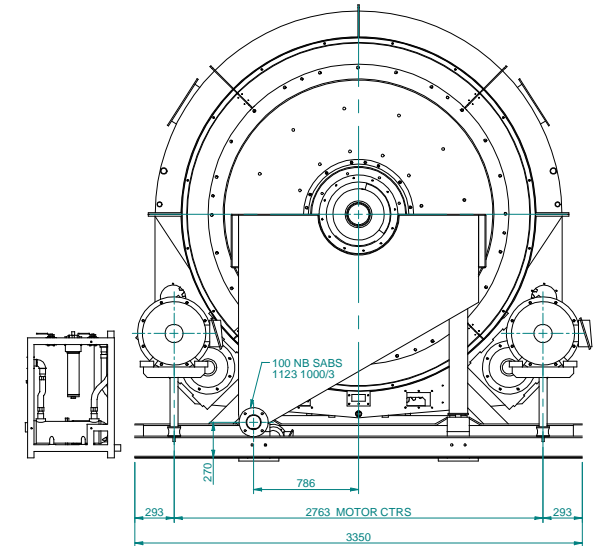
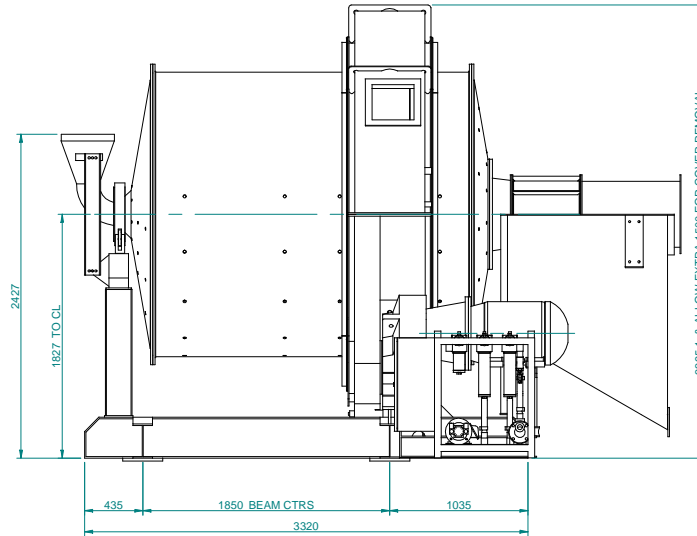
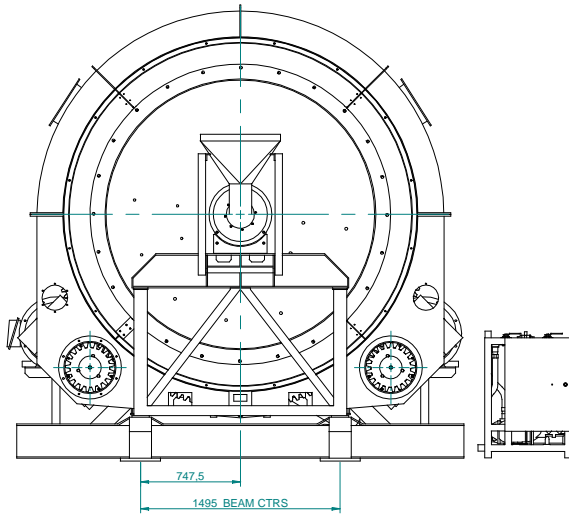

Item Number	Document Number	Title	Quantity	Mass
1	07-0052-4052	DRIVE ASSEMBLY	1	3472.1 kg
2*	07-0052-4002	DRUM ASSEMBLY	1	9184.9 kg
3	07-0052-5018	INLET ASSEMBLY	1	60.1 kg
4	07-0052-5024	BASE FRAME ASSEMBLY	1	892.4 kg
5*	06-0067-9001	DISCHARGE CHUTE	1	450.1 kg
6	05-0033-5092	LUBE SYSTEM	1	157.3 kg

NOTES

- TOTAL INSTALLED POWER 150 KW IE 2X75 KW
- MILL BI DIRECTIONAL AT 81% CRITICAL SPEED (NEW LINERS AND 80MM BALLS) - OPTIONAL SPEEDS AVAILABLE ARE 74% & 68% OF CRITICAL
- DISCHARGE AND FEED DETAILS STILL TO BE VERIFIED

REFERENCE	NO.	DESCRIPTION	DATE	CHECK
	1	FOUNDATION LOADS ADDED	19-03-08	DT

TOLERANCES	DRAWN	DT
ABOVE	INCL MACH FABR CAST	DATE 2007/11/08
0.5	3 0.1 -	CHECKED SE
3	6 0.1 1	DATE 2008/02/21
6	30 0.2 1.5	ENGINEER DT
30	120 0.3 2.5	DATE 2008/02/21
120	315 0.5 3	PROJN 1ST ANGLE
315	1000 0.8 4	MATERIAL
1000	2000 1.2 4.5	matl
2000	5150 1.5 5	

MechProTech (Pty) Ltd.
 Mechanical Product and Technology Development for Industry

2.1M DIA X 2.4M LONG OVERFLOW BALL MILL ASSEMBLY

SCALE: 1:20 DRWG NO: **A1-07-0052-4012** SHEET 1 OF 1